

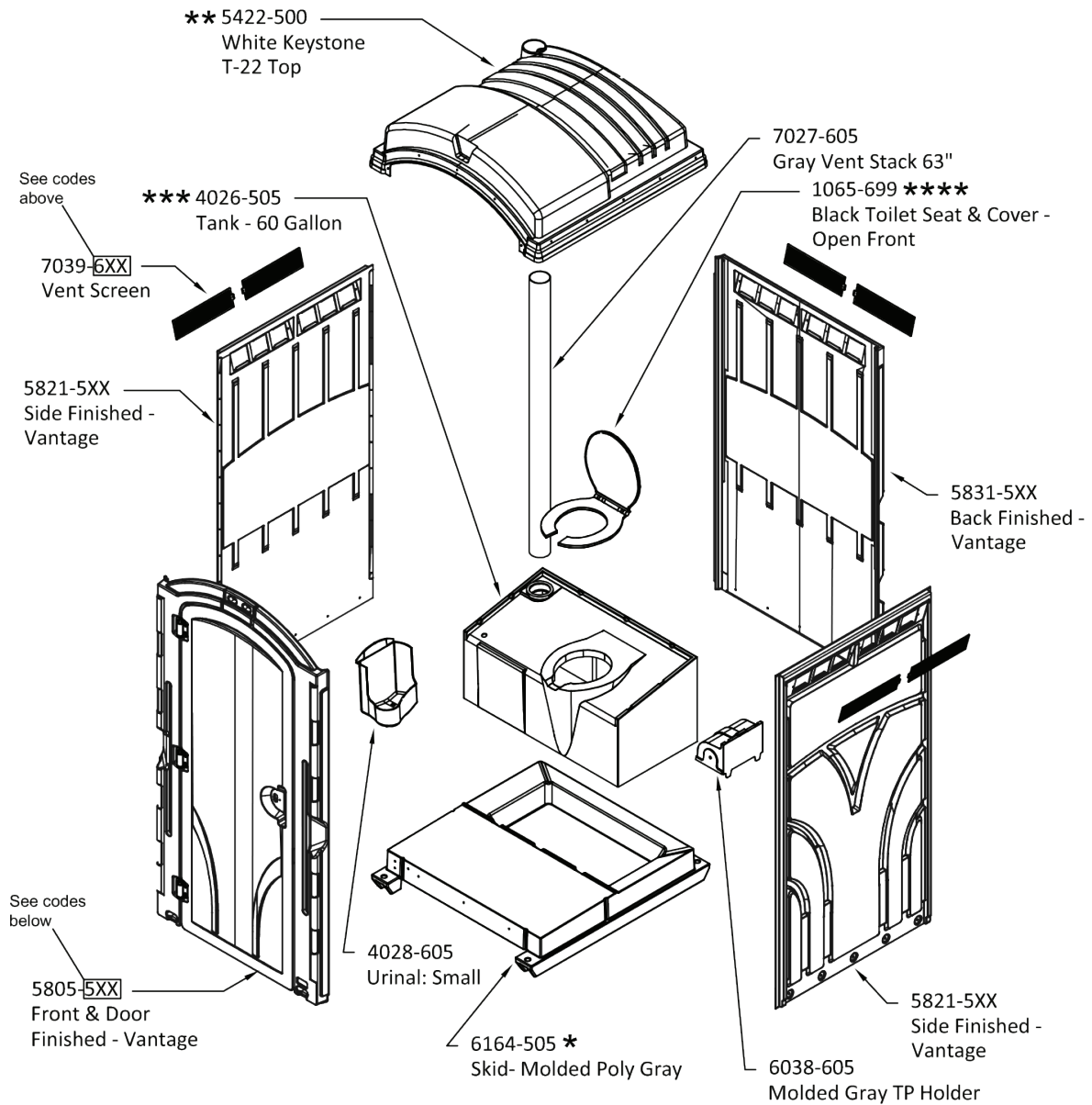

2019 parts catalog

VANTAGE® MAJOR ASSEMBLY (POLYPORTABLES)



VANTAGE COLOR CHART

	Aqua	Blue	Gray	Green	Lime	Orange	Pink	Red
Front Part #	01	03	05	06	08	09	10	11
Panel Part #	01	03	05	06	08	09	10	11
	Silver	Tan	Maroon	Yellow	Turbo Blue	Dark Blue	Grass Green	Purple
Front Part #	12	12	14	17	21	24	26	27
Panel Part #	12	12	14	17	21	24	26	27

VANTAGE® ASSEMBLY (POLYPORTABLES)

PART#	QPU	DESCRIPTION	PRICE
Front and Door Assembly			
5805-503	1	Blue Front & Door Finished - Vantage	
1080-699	1	Door / Hover Handle - Vantage / AXXIS	
1808-699	2	Rivet: 688 Tri-Bulb (coat hook, mirror, slide latch bracket)	
1021-699	3	Hinge: Spring Loaded	
1827-699	12	Rivet: SSB68S (spring hinge)	
1701-699	12	Washer: .1951D x .625 OD x .060 SS Backer Washer	
1081-799-99V	1	Rotary Door Latch with Complete for AXXIS or Vantage Unit	
1081-799	1	Rotary Door Latch with Label	
1076-699	1	Indicator Label for Rotary Latch-Vantage Unit	
1934-699	1	Screw: Shoulder Screw 1/4" D x 2" L Shoulder, 10-24 Thread, SS	
1713-699	1	Washer: 1/4" Stainless Flat	
1771-699	1	Nut: 10-24 Hex SS,Nylon Insert Lock Nut 3/8" x 15/64 High for Rotary Latch	
1705-699	1	Washer: Aluminum 3/16	
1093-699-99	1	Axxis/Vantage Lock Bracket - Complete	
1093-699	2	Lock Bracket (AXXIS)	
1808-699	4	Rivet: 688 Tri-Bulb (coat hook, mirror, slide latch bracket)	
1033-699-99	1	Mirror 6" x 8" Stainless Steel - Complete	
1808-699	4	Rivet: 688 Tri-Bulb (coat hook, mirror, slide latch bracket)	
Side Assembly			
5821-503	2	Blue Side Finished - Vantage	
7039-600-99	6	White Vent Screen - Complete	
1816-699	2	Rivet: ABL66A (corners, urinal, TP cover, vent screens)	
1705-699	2	Washer: Aluminum 3/16	
Top Assembly			
5422-500-99V	1	White Keystone T-22 Top - Complete / Vantage Unit	
1821-699	20	Rivet: Tri-clamp AL0625ATB (Vantage assembly)	
Back Assembly			
5831-503	1	Blue Back Finished - Vantage	
Internal Components			
5092-505-99V	1	Gray Vanity Shelf - Complete/Vantage Unit	
1821-699	10	Rivet: Tri-clamp AL0625ATB (Vantage assembly)	
6037-605-99V	1	Molded Gray 3 Roll TP Holder (New Style) - Complete / Vantage	
1821-699	4	Rivet: Tri-clamp AL0625ATB (Vantage assembly)	
1051-699	1	Toilet Paper Rod for 3 ROLL TP Holder (Black)	
1029-699-99	1	Coat Hook - Complete	
1808-699	2	Rivet: 688 Tri-Bulb (coat hook, mirror, slide latch bracket)	
1038-699	1	Padlock With Key	
4028-605-99V	1	Urinal: Small - Complete / Vantage	
1821-699	2	Rivet: Tri-clamp AL0625ATB (Vantage assembly)	
7027-605-99	1	Gray Vent Stack 63" - Complete	
1814-699	1	Rivet: ABL0640 (vent stack)	

VANTAGE® MAJOR ASSEMBLY (POLYPORTABLES)

PART#	QPU	DESCRIPTION	PRICE
Base and Tank Components			
6164-605-99A	1	Skid: Gray Molded - Complete / AXXIS (Includes front hardware only)	
1923-699	4	Screw: Lag 1/4 X 1 1/2 for Std. Unit	
1713-699	6	Washer: 1/4" Stainless Flat	
4026-605-99V	1	Tank: 60-gal - Complete/Vantage Unit	
1753-699	7	Jacknut 1/4-20	
1940-699	7	Screw: 1/4-20 x1" PHD Pan SS	
1713-699	7	Washer: 1/4" Stainless Flat	
1065-699	1	Black Toilet Seat & Cover - Open Front	
Individual Components			
1709-699	15	Washer: White plastic 1/4 x 1.25	
1821-699	50	Rivet: Tri-clamp AL0625ATB (Vantage assembly)	
1923-699	21	Screw: Lag 1/4 X 1 1/2 for Std. Unit	
1713-699	7	Washer: 1/4" Stainless Flat	

VANTAGE TOILET SPECIFICATIONS

HEIGHT KEYSTONE ROOF: 92" (2336MM)	STANDARD TANK VOLUME: 60 GAL (227L)
LENGTH: 47" (1194MM)	FLOOR SPACE: 41"-21" (1041MM X 533MM)
WIDTH: 43" (1092MM)	SEAT HEIGHT: 18" (457MM)
WEIGHT (ROTO BASE): 200 lbs (75kg)	DOOR SPACING: 73" X 24" (1854MM) X 610MM)

Can't Sleep?

Shop Online and Save 5%



satelliteindustries.com



Regional Managers & Territories



Northwest

John Sprenger

763-519-6544

johns@satelliteindustries.com



Northeast

Josh Carmichael

574-350-2162

joshuac@satelliteindustries.com



South Central

Matt McClure

763-519-6521

mmclure@satelliteindustries.com



Southwest

Tim White

763-519-6543

timw@satelliteindustries.com



Southeast

Gordy Hunt

763-519-6520

ghunt@satelliteindustries.com



Texas

Ryan Foley

763-519-6526

ryanf@satelliteindustries.com



West

Bryan Lowe

763-519-6540

blowe@satelliteindustries.com



North Central

Mark Elhardt

763-551-7230

marke@satelliteindustries.com



Québec

Adrian Tummel

+32/2-542-56-55

adriant@satelliteindustries.com



Mountain

Jeff Sprenger

763-519-6527

jsprenger@satelliteindustries.com



Great Lakes

Paul Jongert

763-519-6546

paulj@satelliteindustries.com

Strategic Account Manager

Ryan Anthony

763-519-6548

ryana@satelliteindustries.com

Online Ordering

satelliteindustries.com | safetfresh.com

Customer Service

Restrooms: 800-883-1123 | Fax: 800-328-3334
Safe-T-Fresh: 877-764-7297 | information@satelliteindustries.com